

SUSPENSION INSULATORS

ANSI Tongue & Clevis Type

U 70 C/SI - N
U 80 C/SI - N
U 120 C/SI - N

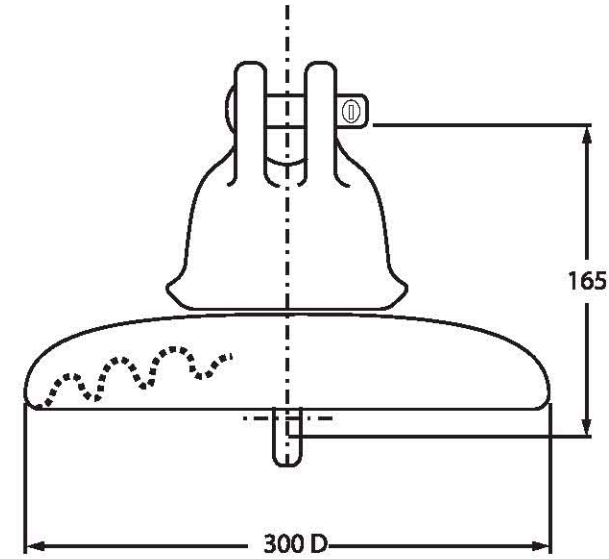
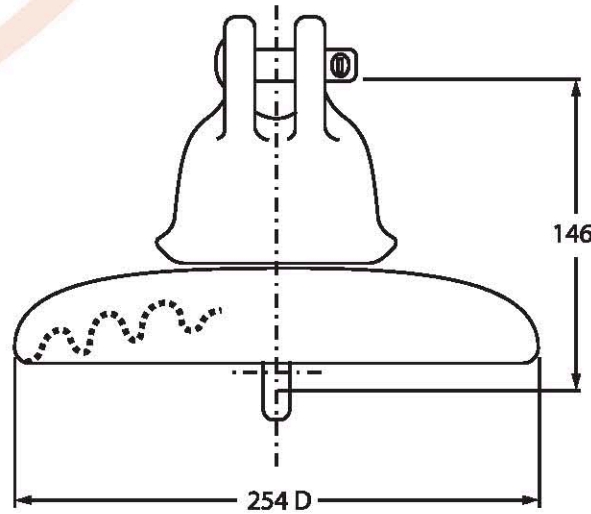

U 160 C/SI - N

CAT. NO.			U 70 C/SI-N	U 80 C/SI-N	U 120 C/SI-N	U 160 C/SI-N
ANSI CLASS			52-4	-	52-6	52-10
Porcelain Disc Diameter		mm	254	254	254	300
Unit Spacing		mm	146	146	146	165
Leakage Distance		mm	292	292	292	318
Combined M & E Strength		kN	70	80	120	160
Mechanical Impact Strength		N-m	6	10	11	11
Tension Proof Test Load		kN	35	40	60	80
Average Flashover Voltage	Low Frequency Dry	kV	80	80	80	80
	Low Frequency Wet	kV	50	50	50	50
	Critical Impulse Positive	kV	125	125	125	125
	Critical Impulse Negative	kV	130	130	130	130
Low Frequency Puncture Voltage		kV	110	110	110	110
Radio - Influence Voltage Data	Test Voltage to Ground	kV	10	10	10	10
	Maximum RIV AT 1000 KHz	μV	50	50	50	50
Weight Per Piece		kg	5.45	5.45	5.45	7.00

Standard Specifications: ANSI C29.2-1992
Zinc Sleeve can be provided on request

SUSPENSION INSULATORS

ANSI Ball & Socket Type

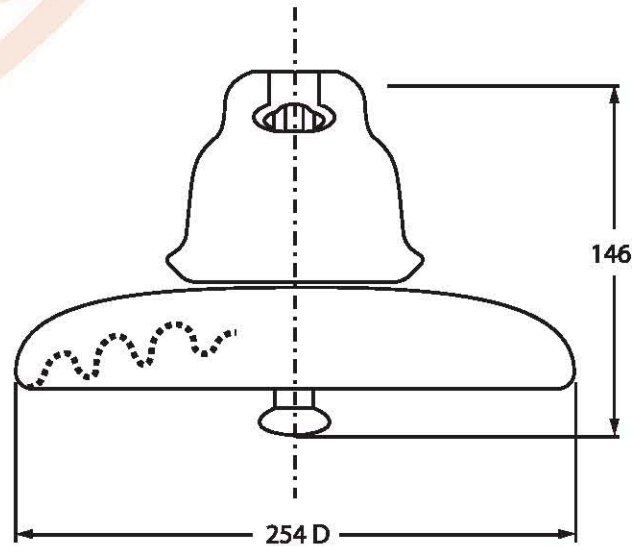

U 70 C/SI - N
U 80 C/SI - N
U 120 C/SI - N

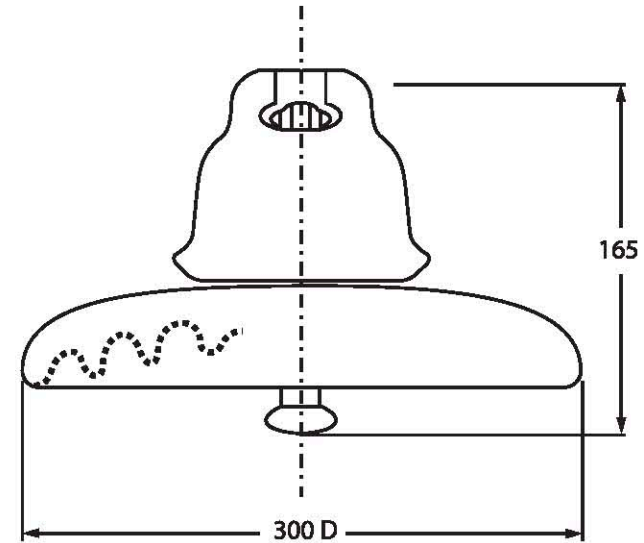

U 160 C/SI - N

CAT. NO.		U 70 B/SI-N	U 80 B/SI-N	U 120 B/SI-N	U 160 B/SI-N
ANSI CLASS		52-3	-	52.5	52.8
Porcelain Disc Diameter		mm 254	254	254	300
Unit Spacing		mm 146	146	146	165
Leakage Distance		mm 292	292	292	318
Combined M & E Strength		kN 70	80	120	160
Mechanical Impact Strength		N-m 6	10	11	11
Tension Proof Test Load		kN 33	40	56	80
Average Flashover Voltage	Low Frequency Dry	kV 80	80	80	80
	Low Frequency Wet	kV 50	50	50	50
	Critical Impulse Positive	kV 125	125	125	125
	Critical Impulse Negative	kV 130	130	130	130
Low Frequency Puncture Voltage		kV 110	110	110	110
Radio - Influence Voltage Data	Test Voltage to Ground	kV 10	10	10	10
	Maximum RIV AT 1000 KHz	μ V 50	50	50	50
Weight Per Piece		kg 5.45	5.45	5.45	7.00

Standard Specifications: ANSI C29.2-1992
Zinc Sleeve can be provided on request

SUSPENSION INSULATORS

IEC Tongue & Clevis and Ball & Socket Type

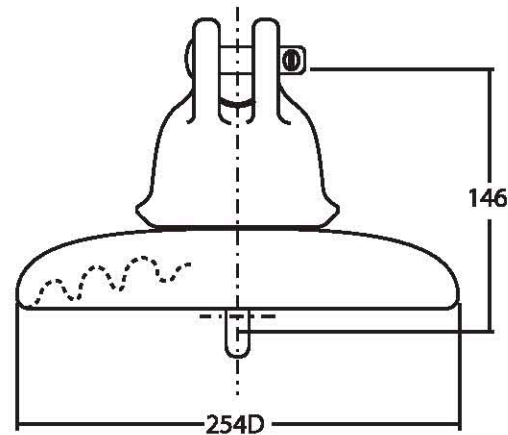

U 70 C/E-N
U 80 C/E-N
U 100 C/E-N
U 120 C/E-N

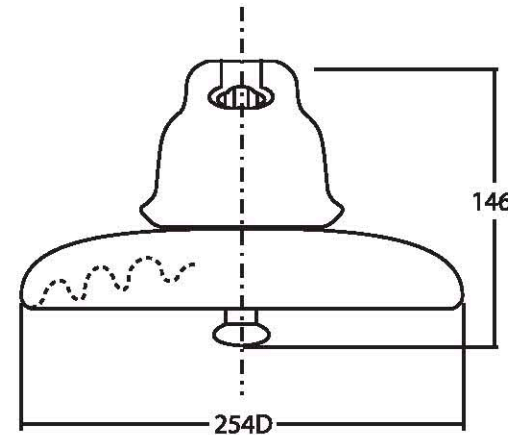

U 70 B/E - N
U 80 B/E - N
U 100 B/E - N
U 120 B/E - N

CAT. NO.			UB 70 C/E-N UB 70 B/E-N	UB 80 C/E-N UB 80 B/E-N	UB 100 C/E-N UB 100 B/E-N	UB 120 C/E-N UB 120 B/E-N
Porcelain Disc Diameter		mm	254	254	254	254
Unit Spacing		mm	146	146	146	146
Leakage Distance		mm	292	292	292	292
Combined M & E Strength		kN	70	80	100	120
Mechanical Impact Strength		N-m	35	40	50	60
Tension Proof Test Load		kN	78	78	78	78
Average Flashover Voltage	Low Frequency Dry	kV	45	45	45	45
	Low Frequency Wet	kV	120	120	120	120
	Critical Impulse Positive	kV	125	125	125	125
	Critical Impulse Negative	kV	70	70	70	70
Low Frequency Puncture Voltage		kV	40	40	40	40
Radio - Influence Voltage Data	Test Voltage to Ground	kV	110	110	110	110
	Maximum RIV AT 1000 KHz	V	110	110	110	110
Weight Per Piece		kg	5.45	5.45	5.45	5.45

Testing Specifications: IEC Pub:383 - 1:-1993
Zinc Sleeve can be provided on request